

The following AC induction motors are especially designed for small electric vehicles.
 The motors are watercooled and can be supplied with:

- reduction and a differential gear
- mechanical or electronic speedometer command (option).

Technical data

		Motor type					
		135-75	135-100	135-125	135-150	200-75	200-100
Nominal power (S1)	kW	3.5	5	6.2	7.5	9	12
Nominal torque (S1)	Nm	11.5	16.5	20	25	30	40
Dimension "A"	mm	184	209	234	259	216	241
Dimension "B" ø	mm	164	164	164	164	235	235
Weight	kg	12	15	18	21	34	38
Nominal speed	rpm	2'850	2'850	2'850	2'850	2'850	2'850
Max. speed	rpm	12'000	12'000	12'000	12'000	9'000	9'000
Cooling		water	water	water	water	water	water

The information contained herewith is subject to change without notice

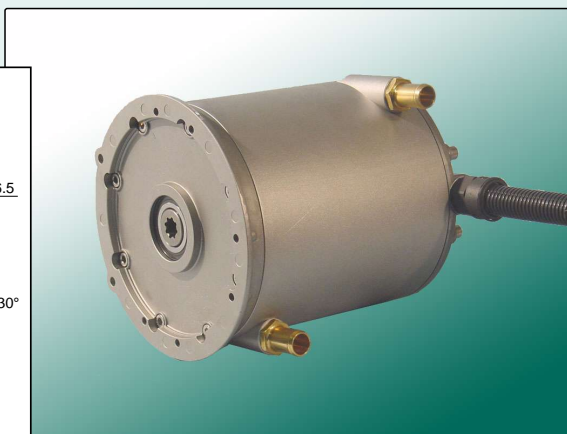
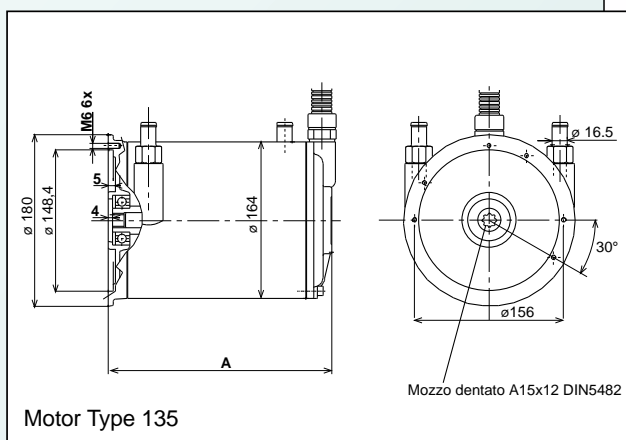

Technical data Reduction and differential gear

Gear ratio 15:1 -12:1 - 10:1

Weight kg 14.3

